

Note that all unique customer requirements (i.e tolerance) need to be verified thru Alfa Laval.

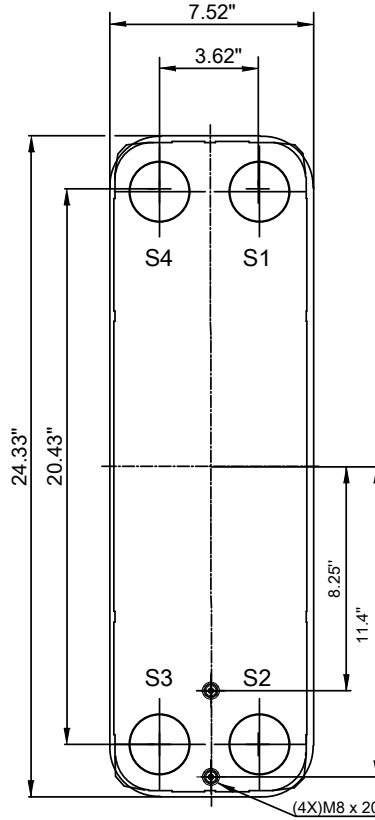
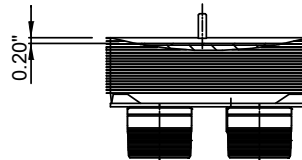
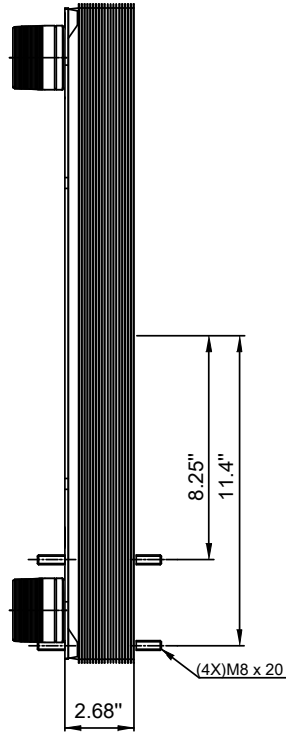
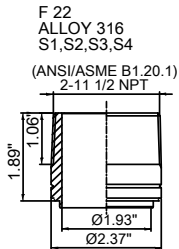

T1 T2 T3 T4 locations on back side correspond to S1 S2 S3 S4 on front side

HEATING SURFACE ft<sup>2</sup>  
 NETWEIGHT 36.1 lb  
 OPERATING WEIGHT lb  
 PLATE MATERIAL ALLOY 316  
 PLATE GROUPING 1\*9H/1\*10H

ALL DIMENSIONS IN INCHES

SIDE	MEDIA	INLET	TEMP.	OUTLET	TEMP.	FLOW RATE	PRESSURE DROP	LIQUID VOL.
1	Water	S1	°F	S2	°F	lb/h	psi	0.09 ft <sup>3</sup>
2	Water	S3	°F	S4	°F	lb/h	psi	0.08 ft <sup>3</sup>

PRESSURE VESSEL APPROVAL

PED/CRN



AlfaNova 76-20H (3287000886)

www.alfalaval.com

CUSTOMER NAME / REF. NO.

TOTAL LENGTH 5.2 in  
 TOTAL WIDTH 7.5 in  
 TOTAL HEIGHT 24.3 in

COMPANY / REF.  
 Alfa Laval Nordic AB  
 Alfa Laval Inc.



8/25/2021  
 REV 0